

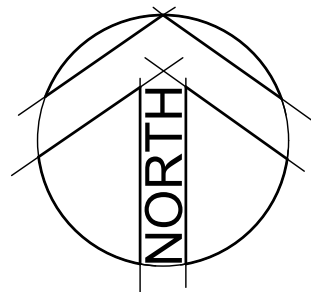

PROPOSED RESIDENTIAL DEVELOPMENT & CABINS  
4948 CLARENCE TOWN ROAD, TABBIL CREEK NSW 2420  
FOR: MR G. MONK C/- FUTUREBUILD GROUP PTY LTD

DRAWING REGISTER - CIVIL	
24006-CI-001	COVER SHEET, SITE LOCATION AND DRAWING REGISTER
24006-CI-002	NOTES SHEET
24006-CI-010	SITE PLAN - PROPOSED DRIVEWAY LAYOUT
24006-CI-015	RAINWATER/OSD TANK DETAILS
24006-CI-016	INFILTRATION TRENCH DETAILS - TYPICAL
24006-CI-021	DRIVEWAY DETAILS - TYPICAL CROSS SECTIONS
24006-CI-022	DRIVEWAY DETAILS - LONG SECTIONS
24006-CI-030	WATER TANK CATCHMENTS
24006-CI-035	SEDIMENT AND EROSION CONTROL PLAN
24006-CI-036	SEDIMENT AND EROSION CONTROL DETAILS
24006-CI-050	SWEPT PATHS - PASSENGER VEHICLE ALL BUILDINGS



LOCATION  
OF WORKS



LOCALITY PLAN  
NTS

1	22/05/24	PRELIMINARY - FOR APPROVAL	IB	DB
REV	DATE	REVISIONS	DRN	CHK

DESIGNED: DB	DATUM: AHD	A1
DRAWN: IB	COORDINATE SYSTEM:	
CHECKED: VC		
RECOMMENDED:	APPROVED:	
PROJECT MANAGER DATE	PROJECT DIRECTOR DATE	

CUBO CONSULTING PTY LTD  
ABN: 46 610 277 452  
Elizabeth Court - Shop 16, 30 Karalla Road, Erina NSW  
Phone: (02) 4328 0990 Email: admin@cubo.net.au

MR G. MONK c/- FUTUREBUILD GROUP P/L  
PROPOSED RESIDENTIAL DEVELOPMENT & CABINS  
4948 CLARENCE TOWN ROAD  
TABBIL CREEK NSW 2420  
COVER SHEET, SITE LOCATION AND DRAWING REGISTER

DRAWING STATUS:	FOR APPROVAL
NOT TO BE USED FOR CONSTRUCTION PURPOSES	
DRAWING NUMBER:	24006-CI-001
REV	1







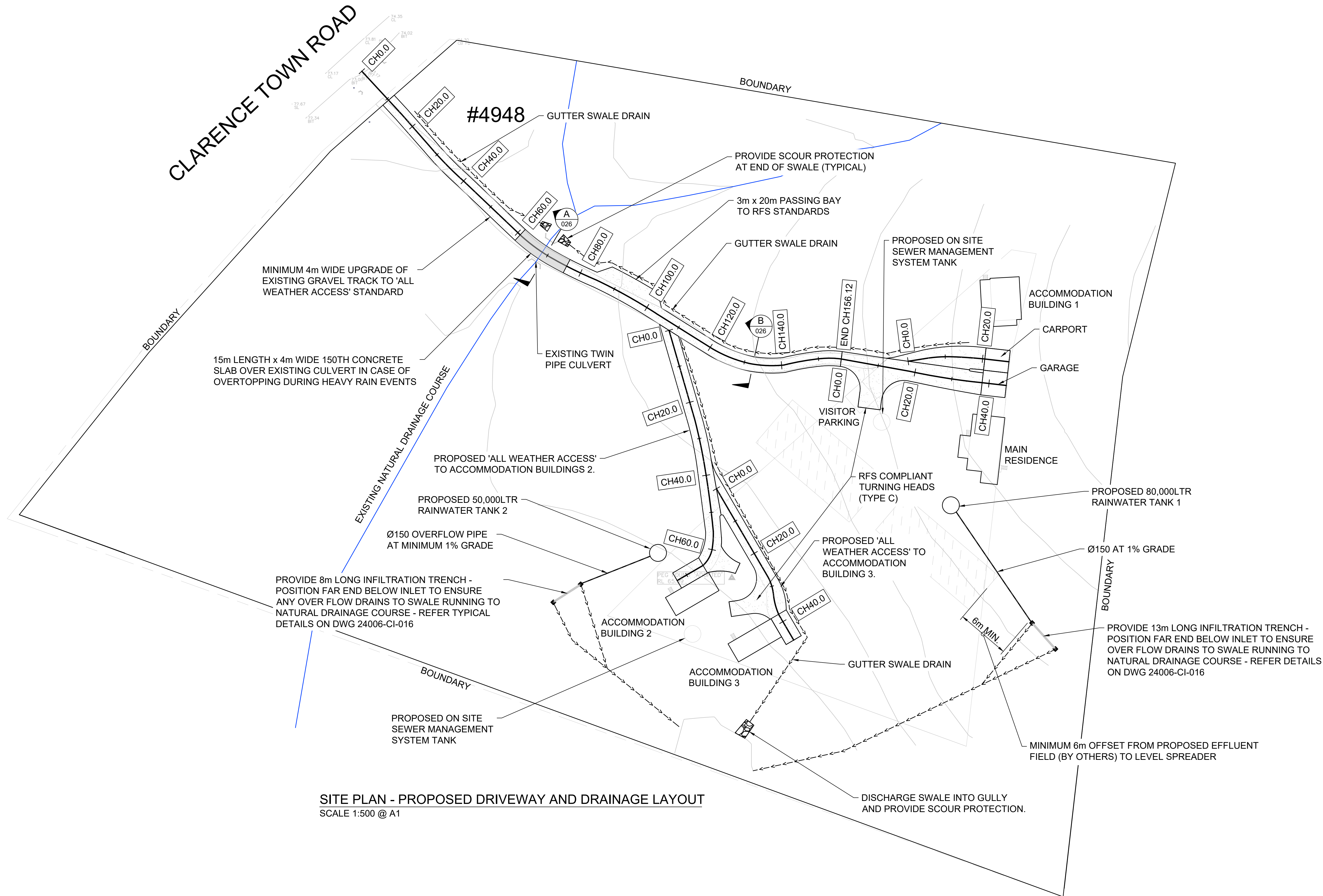

SITE PLAN - PROPOSED DRIVEWAY AND DRAINAGE LAYOUT  
SCALE 1:500 @ A1

1	22/05/24	PRELIMINARY - FOR APPROVAL	IB	DB	
REV	DATE	REVISIONS	DRN	CHK	

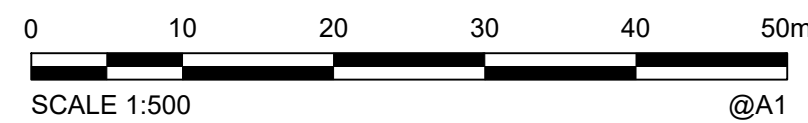

DESIGNED: DB	DATUM: AHD A1
DRAWN: IB	COORDINATE SYSTEM:
CHECKED: VC	
RECOMMENDED:	APPROVED:
PROJECT MANAGER:	PROJECT DIRECTOR:

**CUBO**  
CONSULTING  
CUBO CONSULTING PTY LTD  
ABN: 46 610 277 452  
Elizabeth Court - Shop 16, 30 Karalla Road, Erina NSW  
Phone: (02) 4326 0990 Email: admin@cubo.net.au

MR G. MONK c/- FUTUREBUILD GROUP P/L  
PROPOSED RESIDENTIAL DEVELOPMENT & CABINS  
4948 CLARENCE TOWN ROAD  
TABBIL CREEK NSW 2420  
SITE PLAN - PROPOSED DRIVEWAY LAYOUT

DRAWING STATUS: FOR APPROVAL NOT TO BE USED FOR CONSTRUCTION PURPOSES	REV
DRAWING NUMBER: 24006-CI-010	1

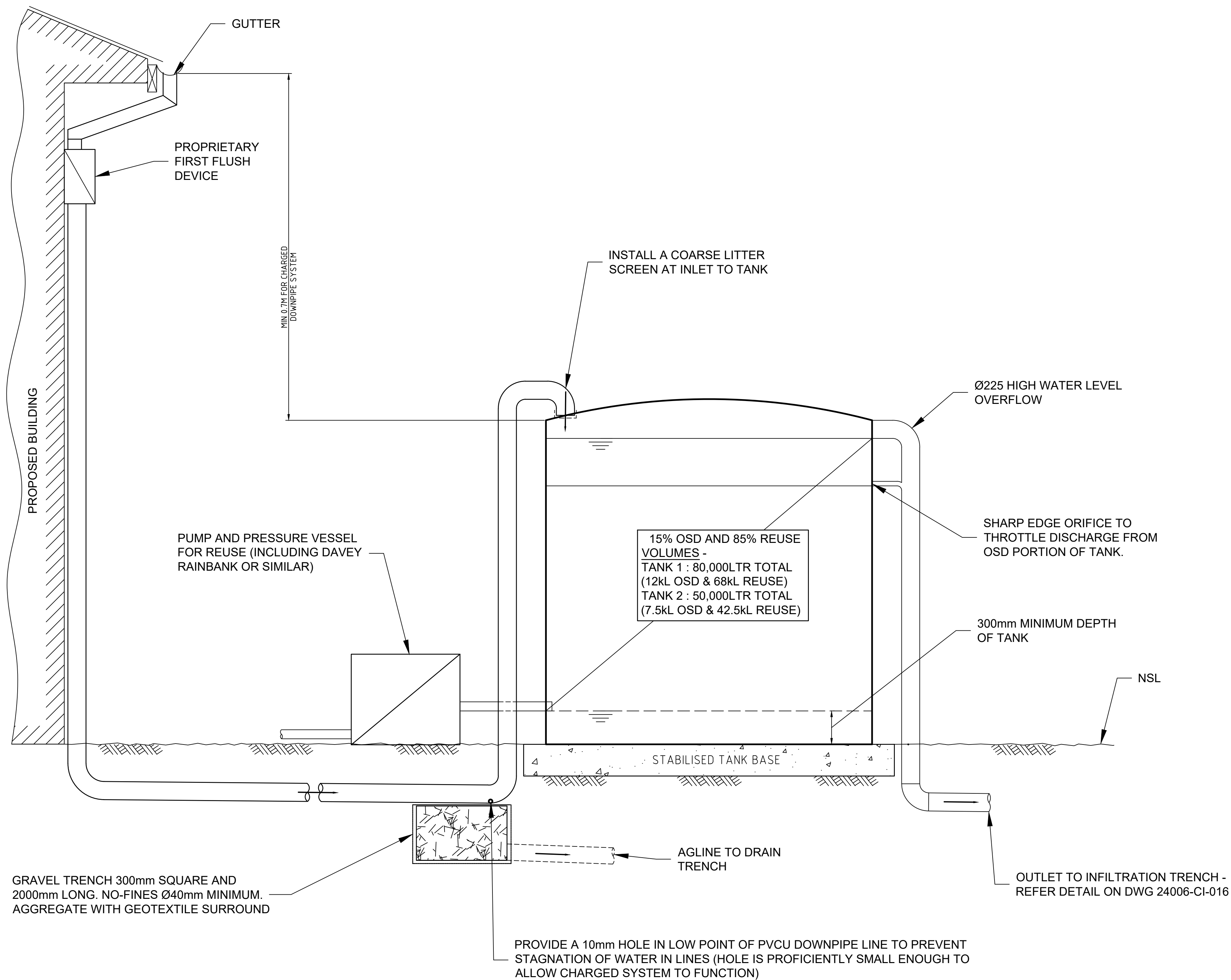

TYPICAL REUSE/OSD ABOVE GROUND TANK DETAIL  
N.T.S

1	22/05/24	PRELIMINARY - FOR APPROVAL	IB	DB	
REV	DATE	REVISIONS	DRN	CHK	



DESIGNED: DB	DATUM: AHD	A1
DRAWN: IB	COORDINATE SYSTEM:	
CHECKED: VC		
RECOMMENDED:	APPROVED:	
PROJECT MANAGER DATE	PROJECT DIRECTOR DATE	

**CUBO**  
CONSULTING  
CUBO CONSULTING PTY LTD  
ABN: 46 610 277 452  
Elizabeth Court - Shop 16, 30 Karalla Road, Erina NSW  
Phone: (02) 4326 0990 Email: admin@cubo.net.au

MR G. MONK c/- FUTUREBUILD GROUP P/L  
PROPOSED RESIDENTIAL DEVELOPMENT & CABINS  
4948 CLARENCE TOWN ROAD  
TABBIL CREEK NSW 2420  
RAINWATER/OSD TANK DETAILS

DRAWING STATUS:	FOR APPROVAL
NOT TO BE USED FOR CONSTRUCTION PURPOSES	
DRAWING NUMBER:	REV
24006-CI-015	1



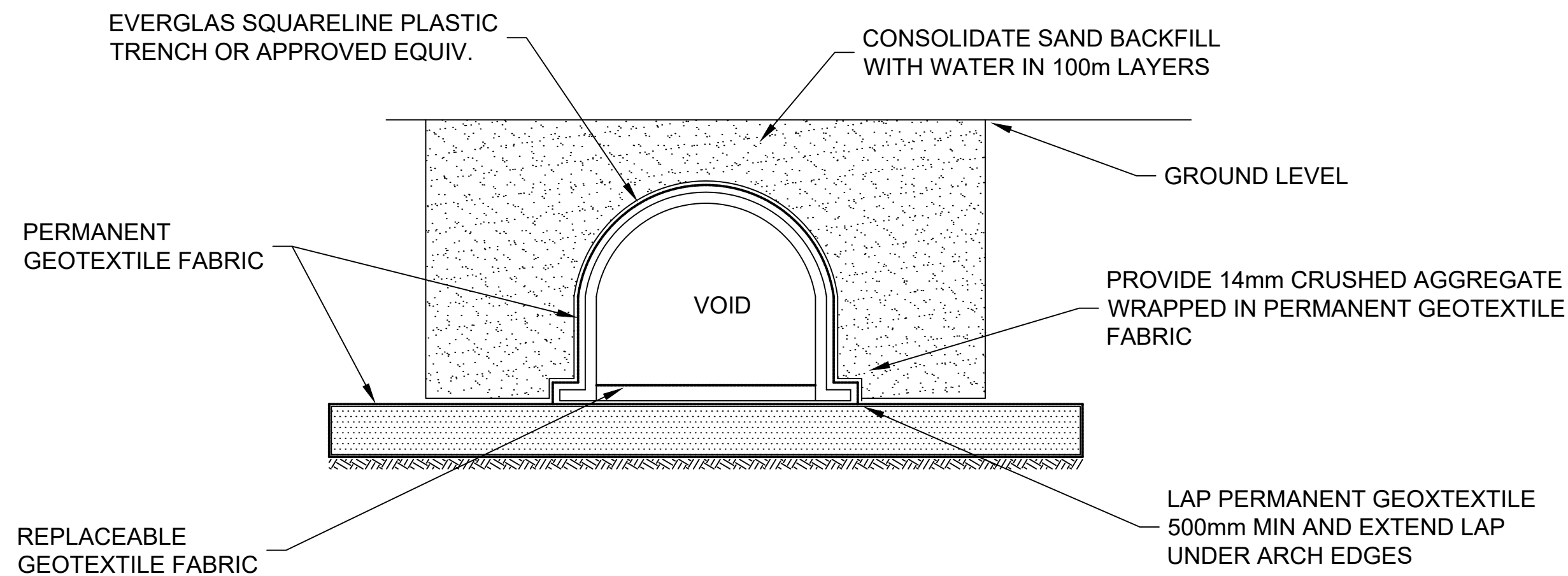

CROSS SECTION  
N.T.S.

1  
016

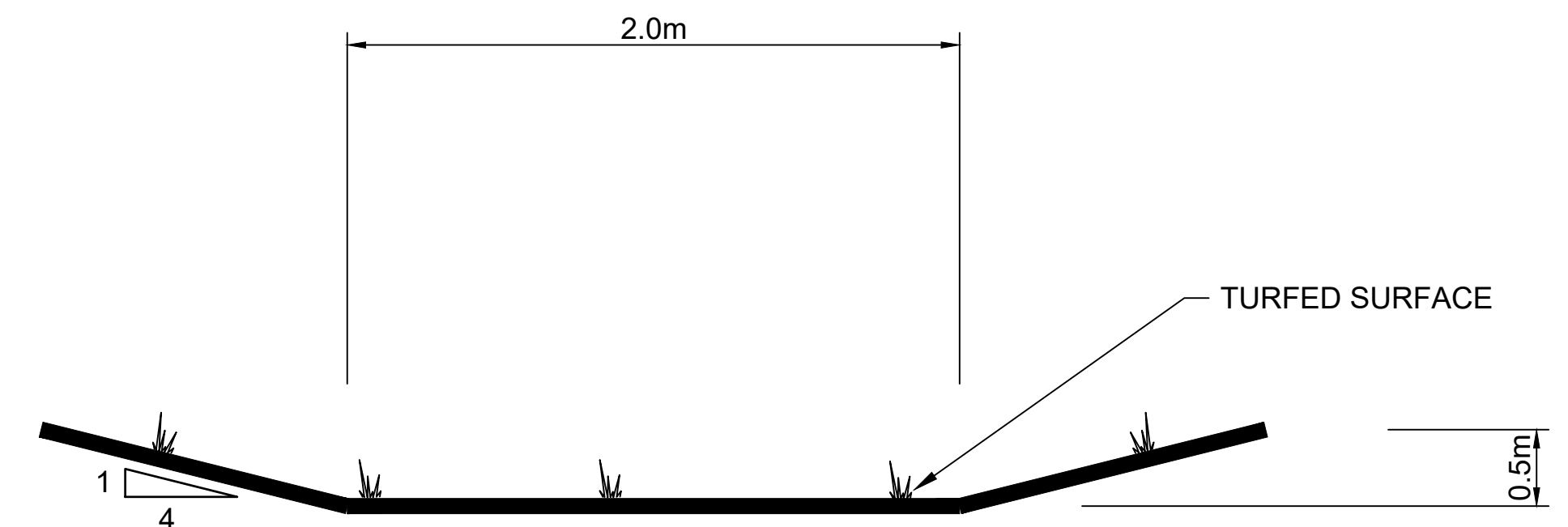

SWALE CROSS SECTION TYPICAL  
SCALE 1 : 20 AT A1

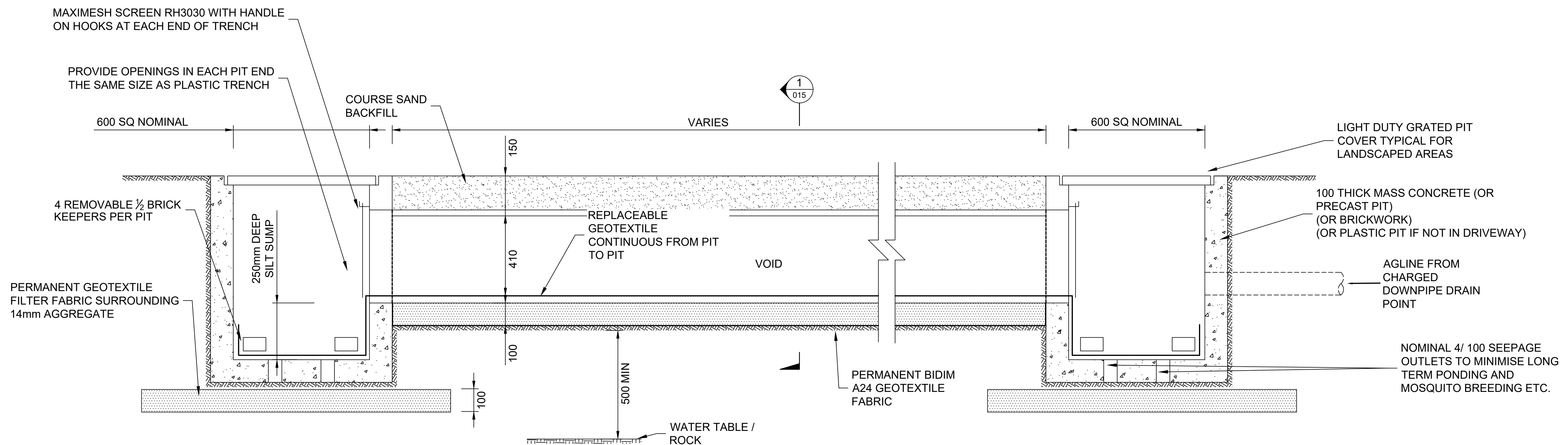

LONGSECTION THROUGH INFILTRATION TRENCH  
N.T.S.

A  
010

NOTE:

ALL UTILITIES ARE TO BE ACCURATELY LOCATED BY CONTRACTOR BEFORE CONSTRUCTION.

REV	DATE	REVISIONS	DRN	CHK
1	22/05/24	PRELIMINARY - FOR APPROVAL	IB	DB

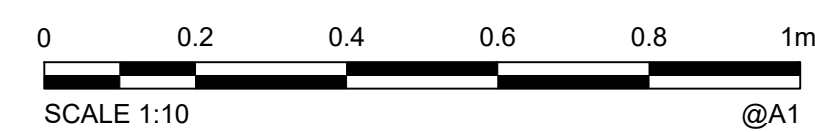

DESIGNED: DB	DATUM: AHD	A1
DRAWN: IB	COORDINATE SYSTEM:	
CHECKED: VC	APPROVED:	
RECOMMENDED:	PROJECT DIRECTOR:	DATE:
PROJECT MANAGER:	DATE:	

**CUBO**

CUBO CONSULTING PTY LTD  
ABN: 46 610 277 452  
Elizabeth Court - Shop 15, 30 Karalla Road, Erina NSW  
Phone: (02) 4326 0990 Email: admin@cubo.net.au

MR G. MONK c/- FUTUREBUILD GROUP P/L  
PROPOSED RESIDENTIAL DEVELOPMENT & CABINS  
4948 CLARENCE TOWN ROAD  
TABBIL CREEK NSW 2420  
INFILTRATION TRENCH DETAILS - TYPICAL

DRAWING STATUS:	FOR APPROVAL
NOT TO BE USED FOR CONSTRUCTION PURPOSES	
DRAWING NUMBER:	24006-CI-016
REV	1

15m LENGTH x 4m WIDE 150TH CONCRETE SLAB OVER EXISTING CULVERT IN CASE OF OVERTOPPING DURING HEAVY RAIN EVENTS

PROVIDE SCOUR PROTECTION ON UPSTREAM AND DOWNSTREAM FACES BETWEEN HEADWALLS AND DRIVEWAY SLAB

PIPES AND HEADWALLS BY OTHERS

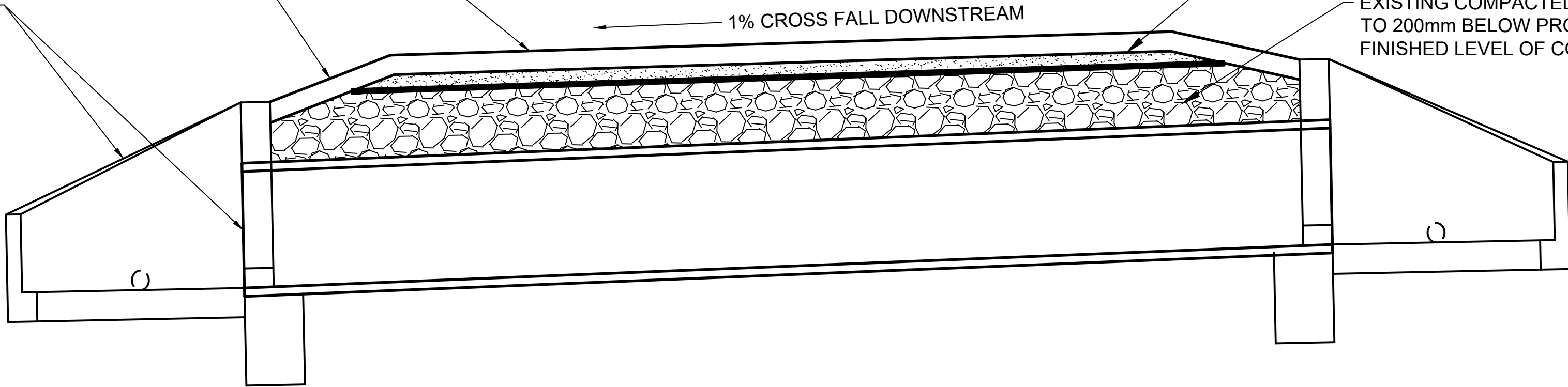

PROPOSED PAVEMENT OVER EXISTING CULVERT CROSS SECTION A  
SCALE 1:20 @ A1

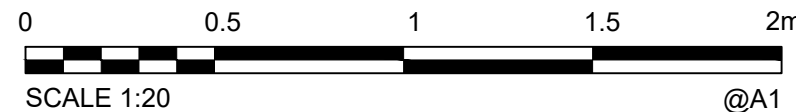

GEOFABRIC (BIDIM A34 OR EQUAL) TO BE LAID OVER TRIMMED FILL WITH 50mm SUITABLE SLAB BASE MATERIAL (1/2 MINUS OR SIMILAR) TO UNDERSIDE OF SLAB.

EXISTING COMPACTED FILL TRIMMED TO 200mm BELOW PROPOSED FINISHED LEVEL OF CONCRETE

PROVIDE CONTRACTION JOINTS - REFER DETAIL BELOW.

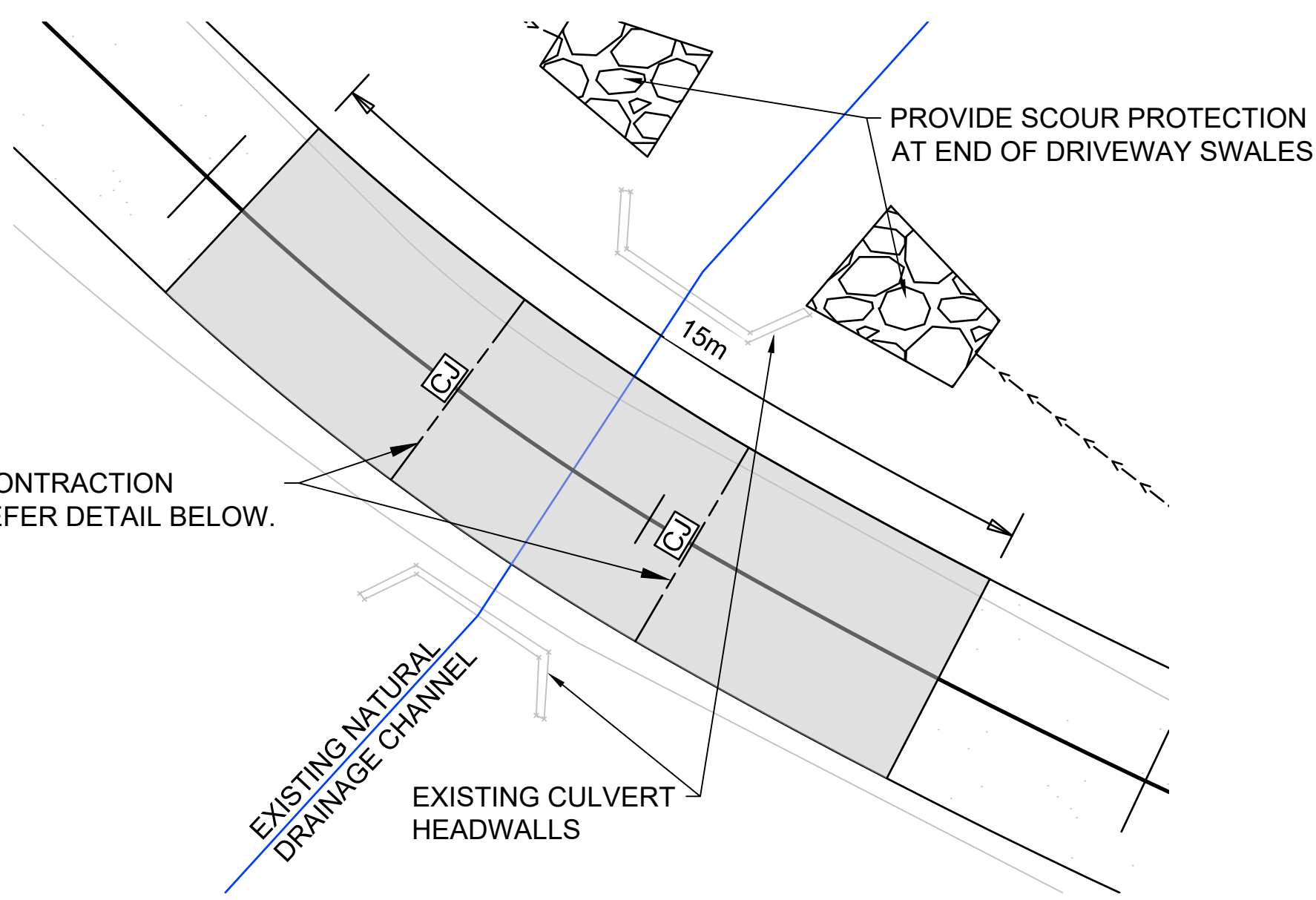

DRIVEWAY SLAB PLAN - DETAILS  
SCALE 1:100 @ A1



LAY GEOFABRIC (BIDIM A34 OR EQUAL) OVER EXISTING GRAVEL DRIVEWAY OR EXPOSED NATURAL GROUND AND CONSTRUCT 4.0m WIDE x 100mm DEEP COMPACTED DGB20 FOR 'ALL WEATHER ACCESS' DRIVEWAY.

PROVIDE 3% CROSS FALL TO TOE OF UPHILL BATTER

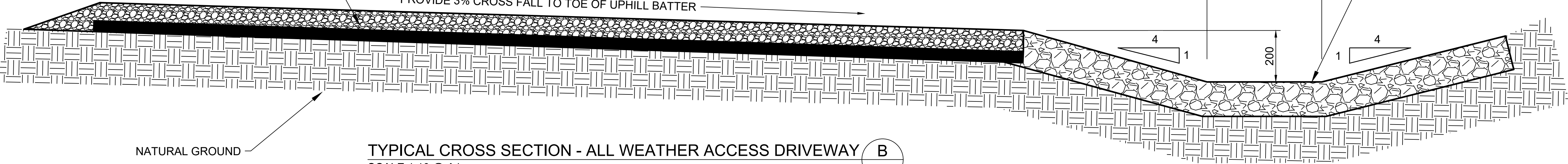

TYPICAL CROSS SECTION - ALL WEATHER ACCESS DRIVEWAY B  
SCALE 1:10 @ A1

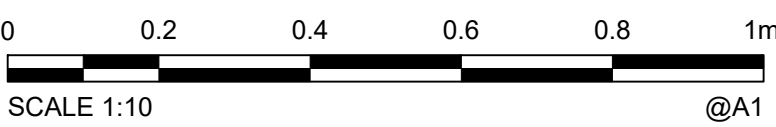

SHAPE 200 DEEP GUTTER AT TOE OF UPHILL BATTER AND PROVIDE SCOUR PROTECTION.

SL82 FABRIC 40 TOP AND SIDE COVER

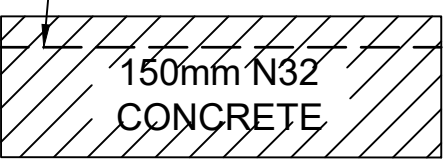

PAVEMENT DETAIL  
N.T.S.

0.3D x 6 WIDE GROOVE RULED AT TIME OF POURING SLAB OR SAWN WITHIN 10 HOURS USING A 'SOFT CUT' SAW. PROVIDE BACKING AND APPROVED POLYSULPHIDE SEALANT.



PROPRIETARY SUPPORT CRADLE  
CONNOLLY PLATE DOWEL GALV. 50x6 @450 Ctr.s.

CONTRACTION JOINT (CJ)  
DOWELS TO BE GALV.  
NTS

NOTE:  
ALL UTILITIES ARE TO BE ACCURATELY LOCATED BY CONTRACTOR BEFORE CONSTRUCTION.

REV	DATE	REVISIONS	DRN	CHK
1	22/05/24	PRELIMINARY - FOR APPROVAL	IB	DB

DESIGNED: DB	DATUM: AHD	A1
DRAWN: IB	COORDINATE SYSTEM:	
CHECKED: VC		
RECOMMENDED:	APPROVED:	
PROJECT MANAGER	DATE	PROJECT DIRECTOR

**CUBO**  
CONSULTING  
CUBO CONSULTING PTY LTD  
ABN: 46 610 277 452  
Elizabeth Court - Shop 16, 30 Karalla Road, Erina NSW  
Phone: (02) 4328 0990 Email: admin@cubo.net.au

MR G. MONK c/- FUTUREBUILD GROUP P/L  
PROPOSED RESIDENTIAL DEVELOPMENT & CABINS  
4948 CLARENCE TOWN ROAD  
TABBIL CREEK NSW 2420  
DRIVEWAY DETAILS - TYPICAL CROSS SECTIONS

DRAWING STATUS: FOR APPROVAL NOT TO BE USED FOR CONSTRUCTION PURPOSES	REV
DRAWING NUMBER: 24006-CI-021	1



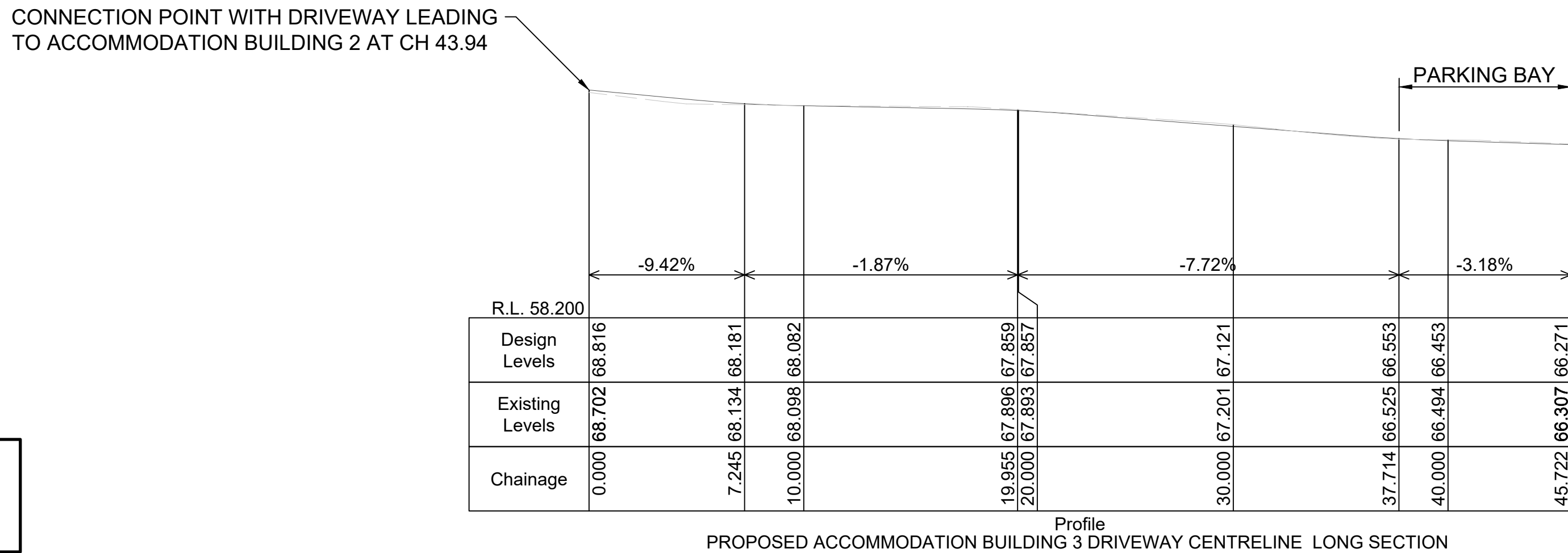
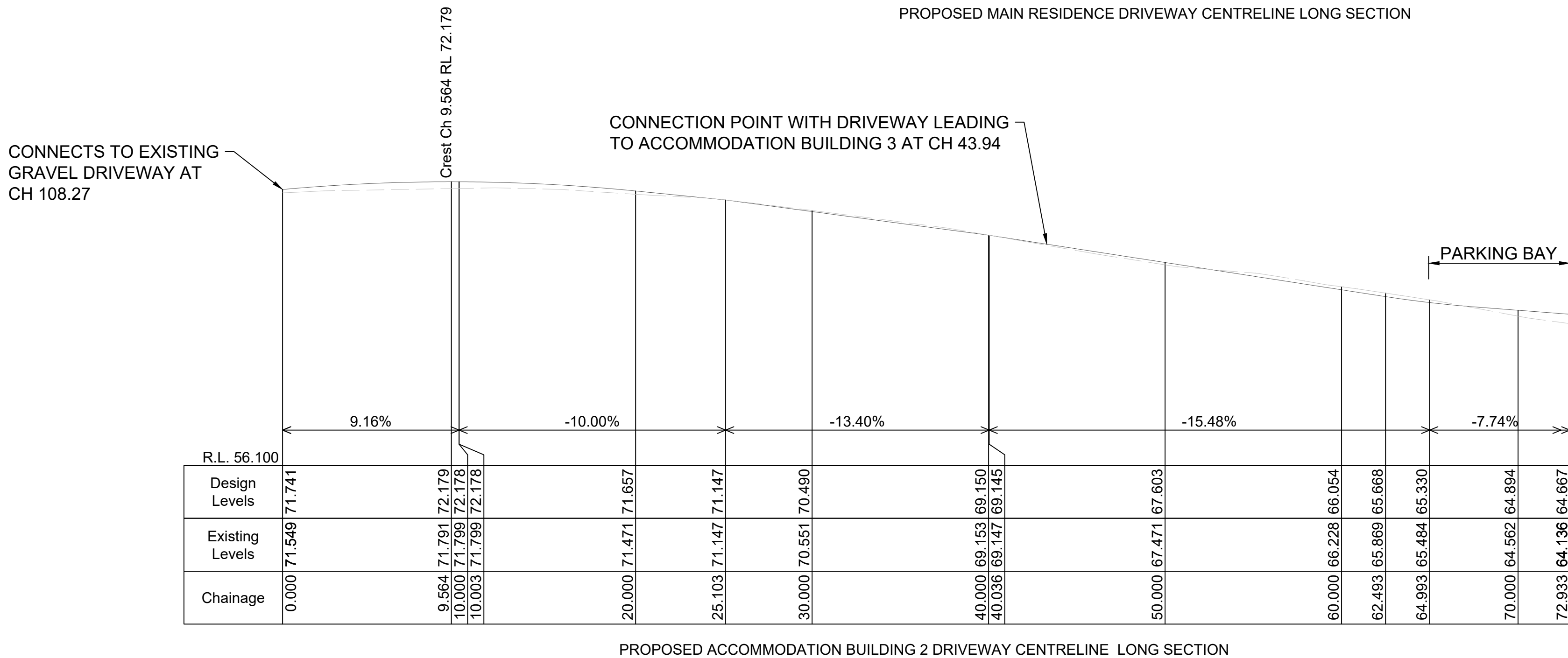
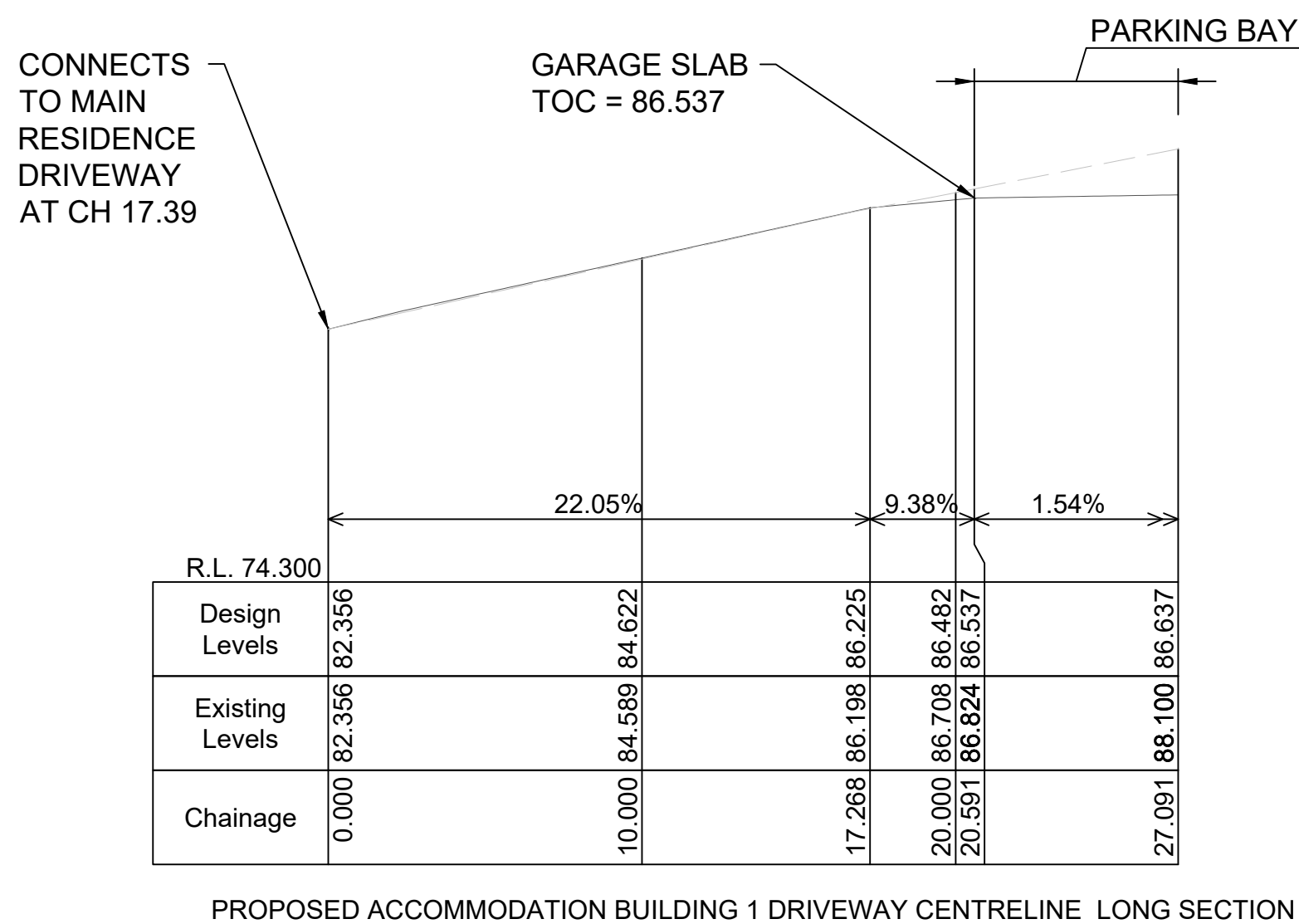
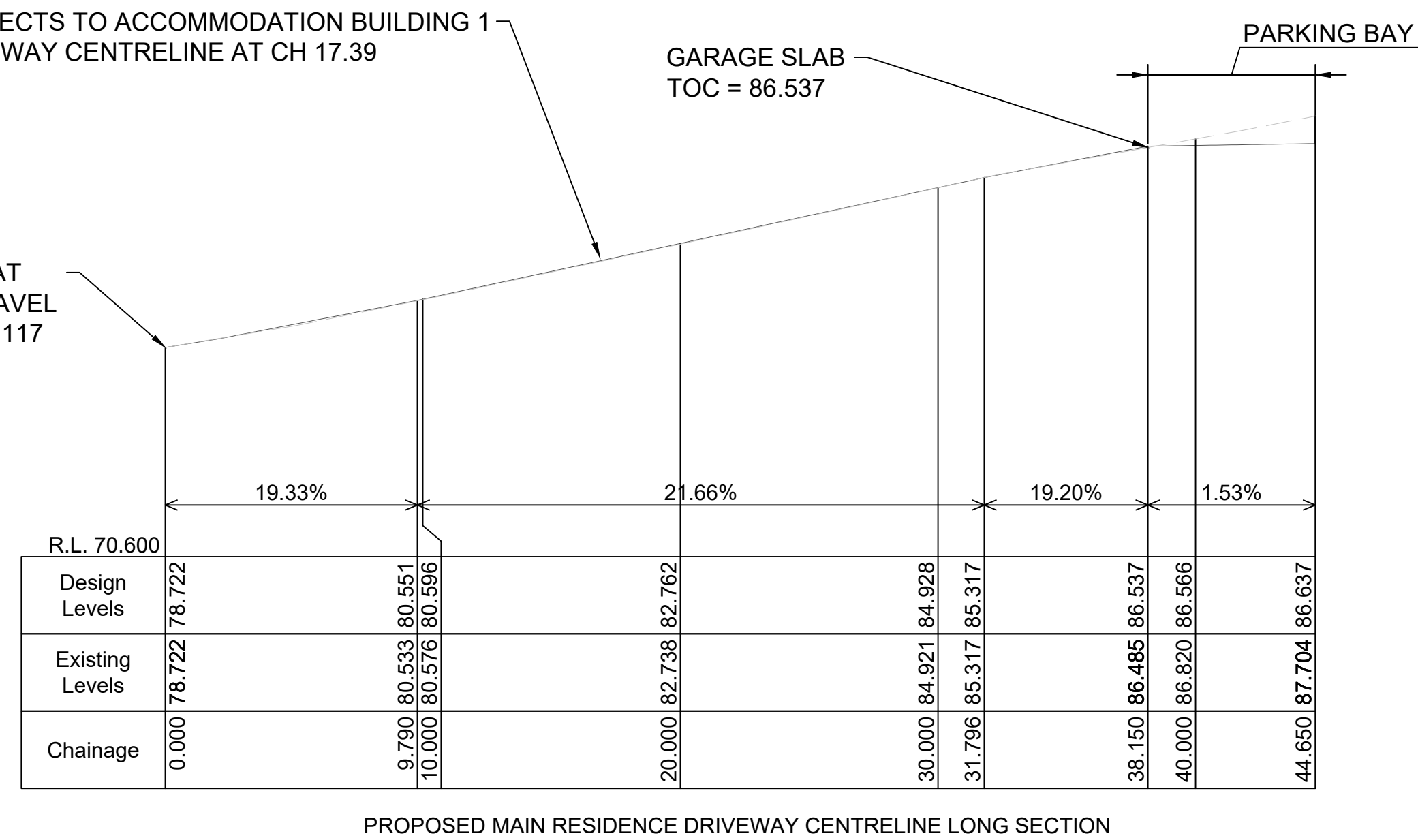
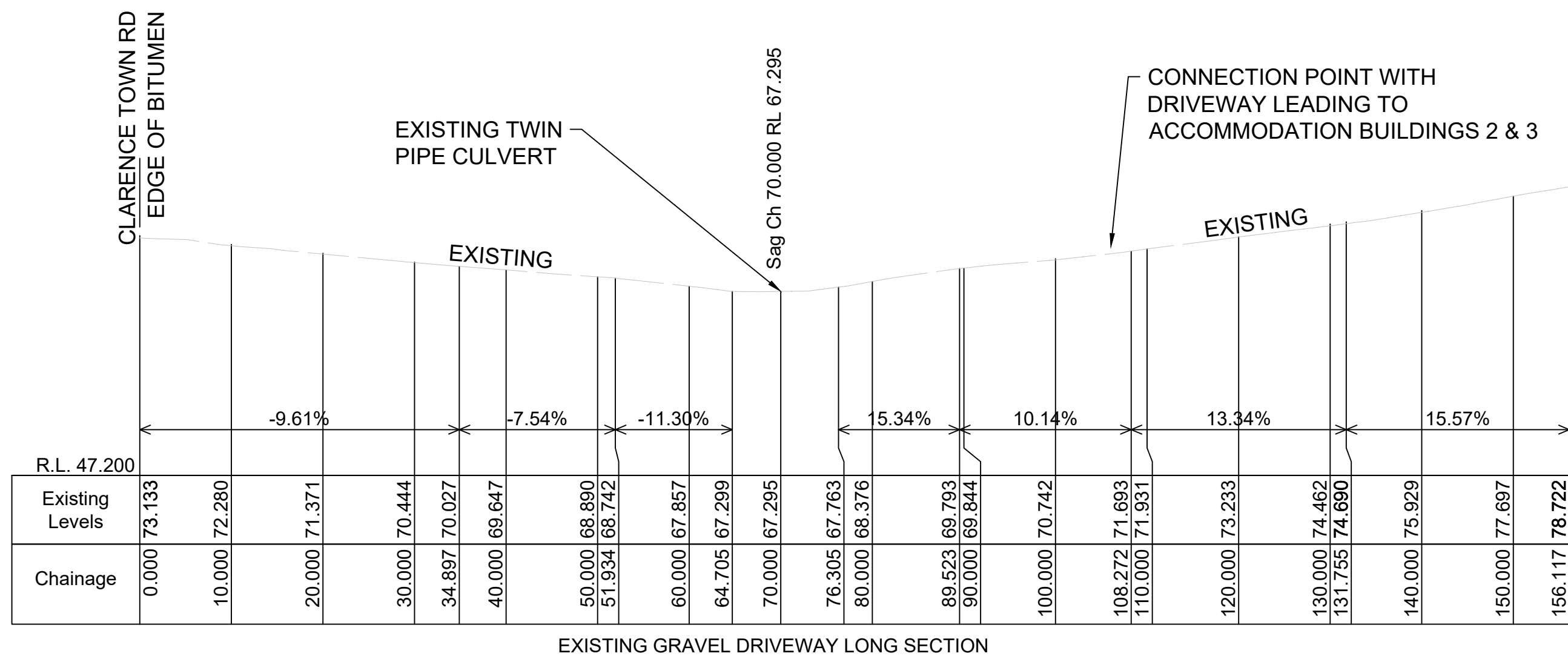

NOTE:  
ALL UTILITIES ARE TO BE ACCURATELY LOCATED BY CONTRACTOR BEFORE CONSTRUCTION.

1	22/05/24	PRELIMINARY - FOR APPROVAL	IB	DB	
REV	DATE	REVISIONS	DRN	CHK	

DESIGNED: DB	DATUM: AHD	A1
DRAWN: IB	COORDINATE SYSTEM:	
CHECKED: VC		
RECOMMENDED:	APPROVED:	
PROJECT MANAGER: DATE	PROJECT DIRECTOR: DATE	

**CUBO**  
CONSULTING  
CUBO CONSULTING PTY LTD  
ABN: 46 610 277 452  
Elizabeth Court - Shop 16, 30 Karilla Road, Erina NSW  
Phone: (02) 4328 0990 Email: admin@cubo.net.au

MR G. MONK c/- FUTUREBUILD GROUP P/L  
PROPOSED RESIDENTIAL DEVELOPMENT & CABINS  
4948 CLARENCE TOWN ROAD  
TABBIL CREEK NSW 2420  
DRIVEWAY DETAILS - LONG SECTIONS

DRAWING STATUS: FOR APPROVAL NOT TO BE USED FOR CONSTRUCTION PURPOSES	REV
DRAWING NUMBER: 24006-CI-022	1



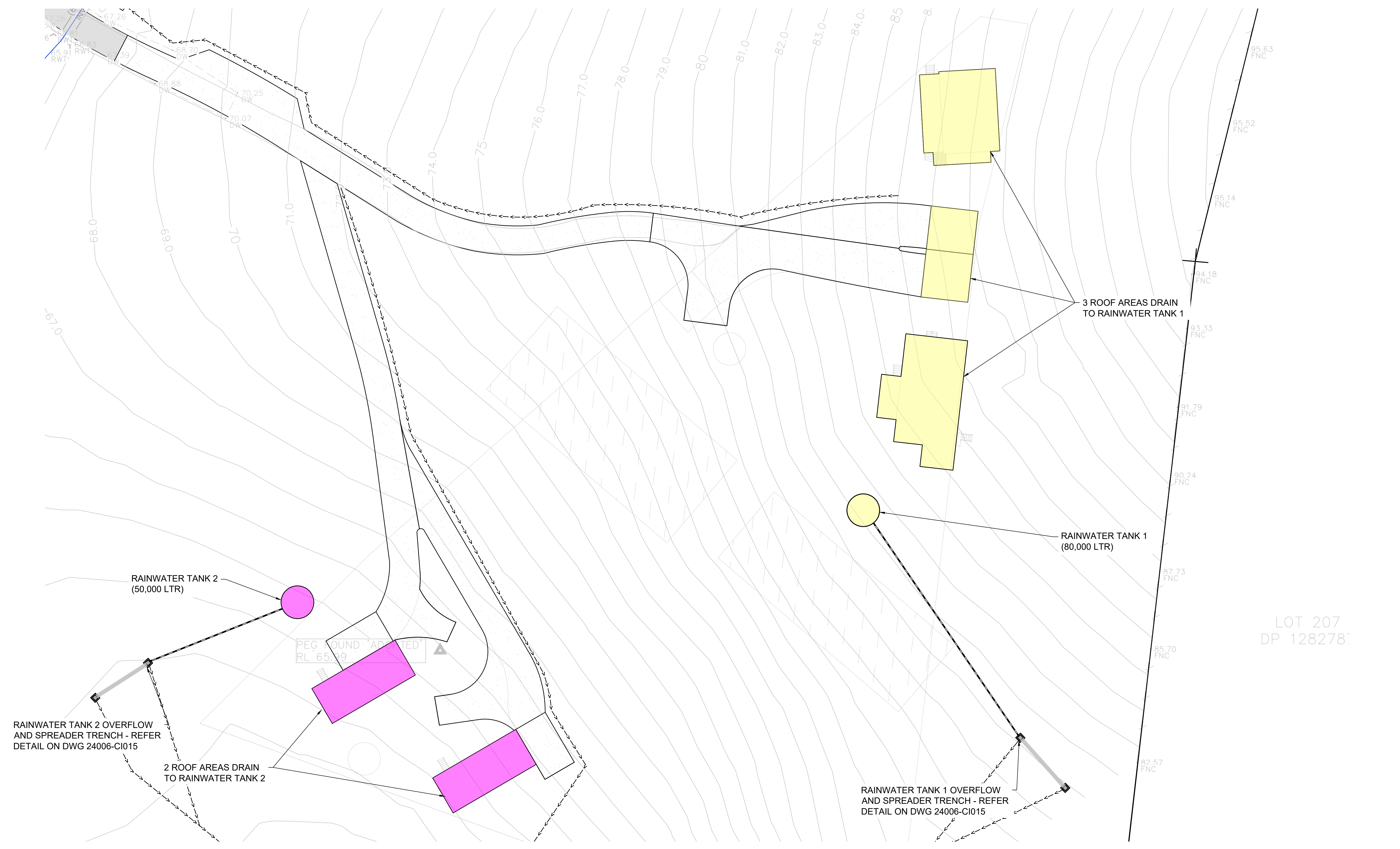

**NOTE:**  
ALL UTILITIES ARE TO BE ACCURATELY LOCATED BY CONTRACTOR BEFORE CONSTRUCTION.

**WATER TANK CATCHMENTS**  
SCALE 1:250 @ A1

1	22/05/24	PRELIMINARY - FOR APPROVAL			IB DB
REV	DATE	REVISIONS			DRN CHK



DESIGNED: DB	DATUM: AHD	A1
DRAWN: IB	COORDINATE SYSTEM:	
CHECKED: VC		
RECOMMENDED:	APPROVED:	
PROJECT MANAGER: .....	DATE: .....	PROJECT DIRECTOR: .....
DATE: .....	DATE: .....	DATE: .....

CUBO CONSULTING PTY LTD  
ABN: 46 610 277 452  
Elizabeth Court - Shop 16, 30 Karalla Road, Erina NSW  
Phone: (02) 4328 0990 Email: admin@cubo.net.au

MR G. MONK c/- FUTUREBUILD GROUP P/L  
PROPOSED RESIDENTIAL DEVELOPMENT & CABINS  
4948 CLARENCE TOWN ROAD  
TABBIL CREEK NSW 2420  
WATER TANK CATCHMENTS

DRAWING STATUS:	
FOR APPROVAL	
NOT TO BE USED FOR CONSTRUCTION PURPOSES	
DRAWING NUMBER:	REV
24006-CI-030	1



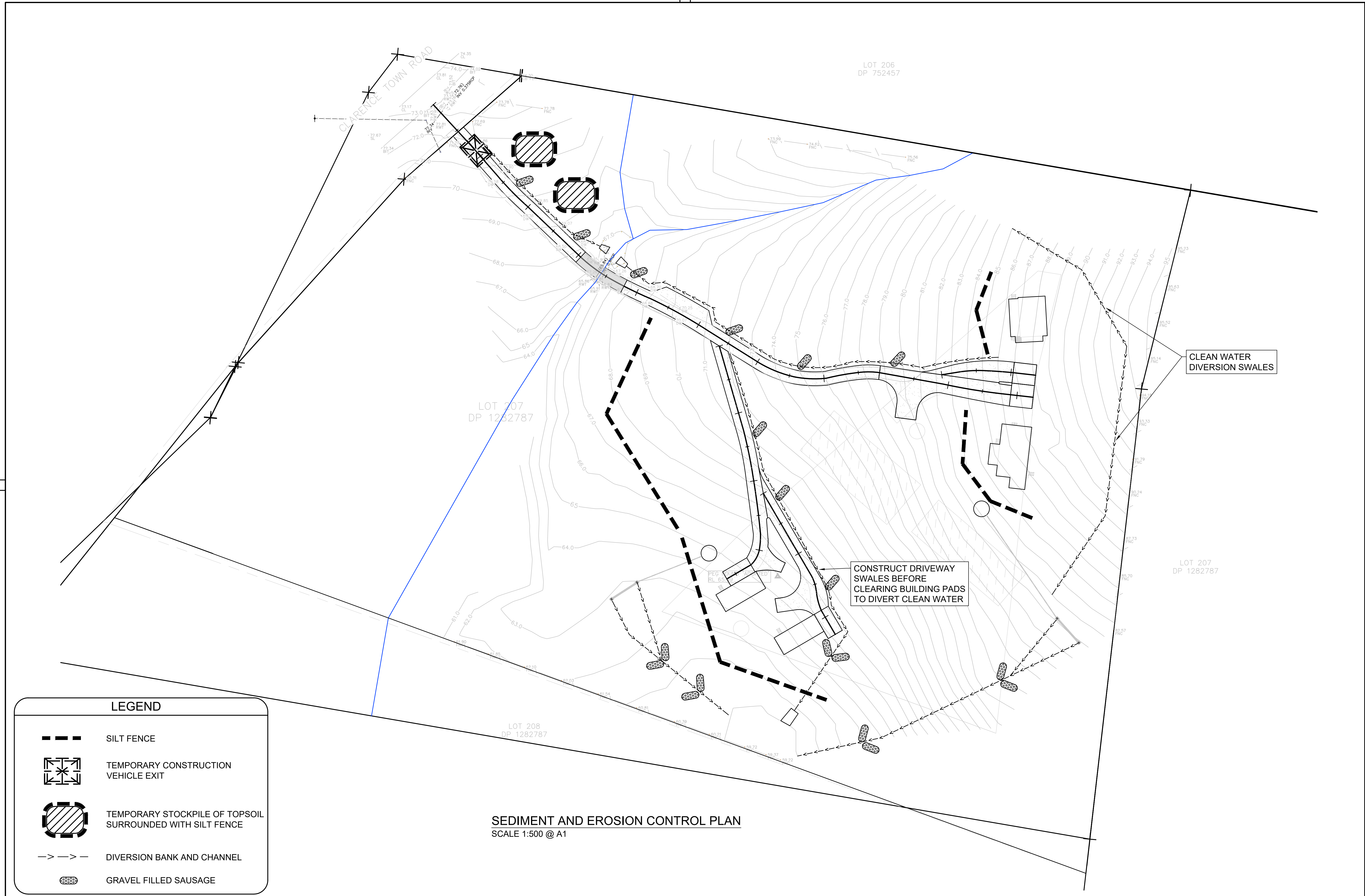

REV	DATE	REVISIONS	DRN	CHK
1	22/05/24	PRELIMINARY - FOR APPROVAL	IB	DB

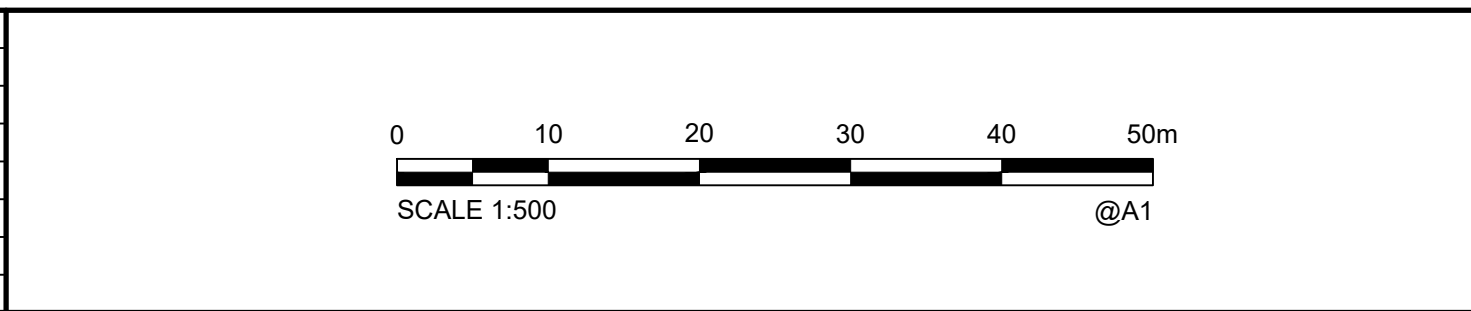

DESIGNED: DB	DATUM: AHD	A1
DRAWN: IB	COORDINATE SYSTEM:	
CHECKED: VC		
RECOMMENDED:	APPROVED:	
PROJECT MANAGER: DATE	PROJECT DIRECTOR: DATE	

**CUBO**  
CONSULTING  
CUBO CONSULTING PTY LTD  
ABN: 46 610 277 452  
Elizabeth Court - Shop 16, 30 Karalla Road, Erina NSW  
Phone: (02) 4326 0990 Email: admin@cubo.net.au

MR G. MONK c/- FUTUREBUILD GROUP P/L  
PROPOSED RESIDENTIAL DEVELOPMENT & CABINS  
4948 CLARENCE TOWN ROAD  
TABBIL CREEK NSW 2420  
SEDIMENT AND EROSION CONTROL PLAN

DRAWING STATUS: <b>FOR APPROVAL</b> NOT TO BE USED FOR CONSTRUCTION PURPOSES	REV
DRAWING NUMBER: <b>24006-CI-035</b>	<b>1</b>



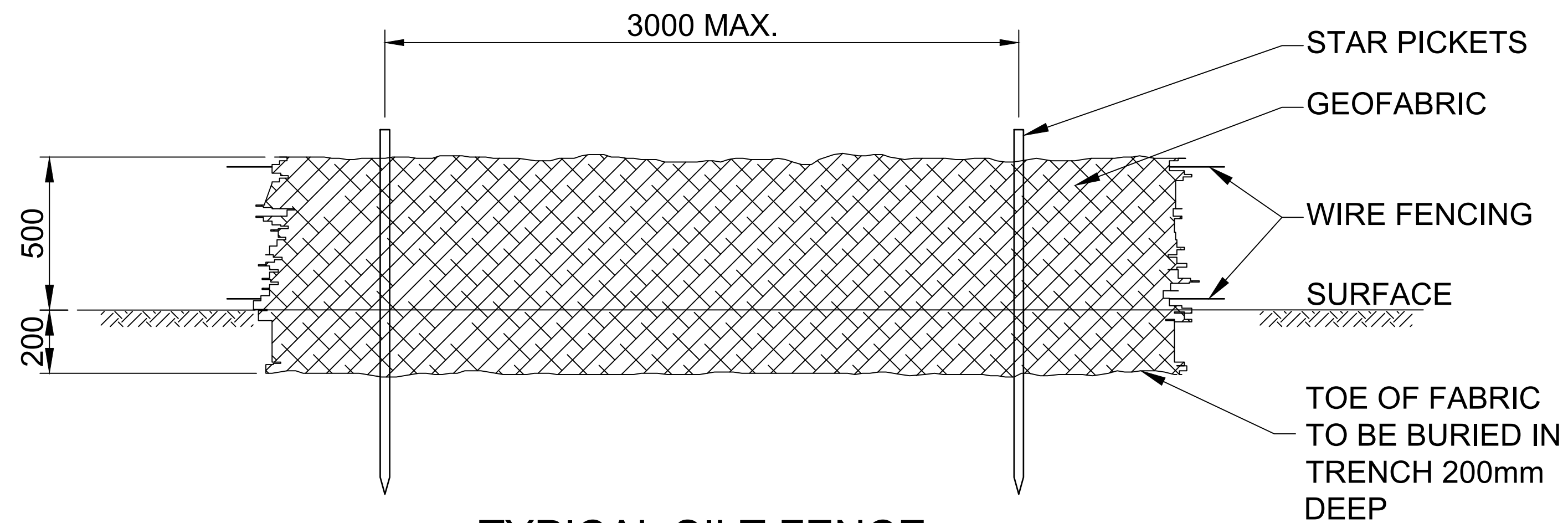

**TYPICAL SILT FENCE  
DETAIL**  
NTS

**NOTE:**  
SEDIMENT BARRIERS TO BE USED ONLY WHERE ROAD WIDTHS  
PERMITS AND WHERE SAFETY TO PASSING TRAFFIC IS NOT AFFECTED

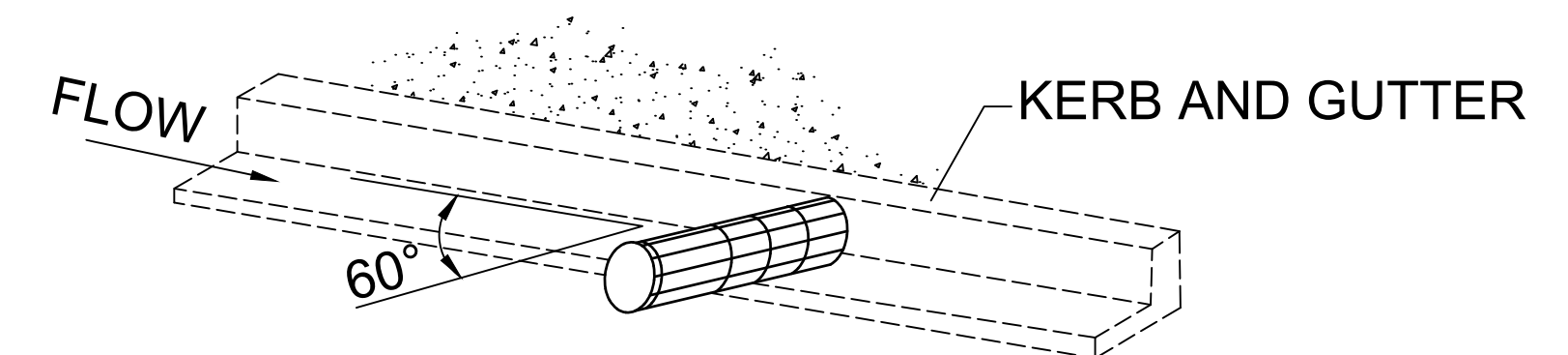

**GRAVEL FILLED SAUSAGE  
TEMPORARY GUTTER GROSS POLLUTANT/SEDIMENT TRAP**

COARSE GRAVEL ROLLED IN NETTING MATERIAL TOTALING  
200mm HIGH & PLACED HARD AGAINST FACE OF KERB

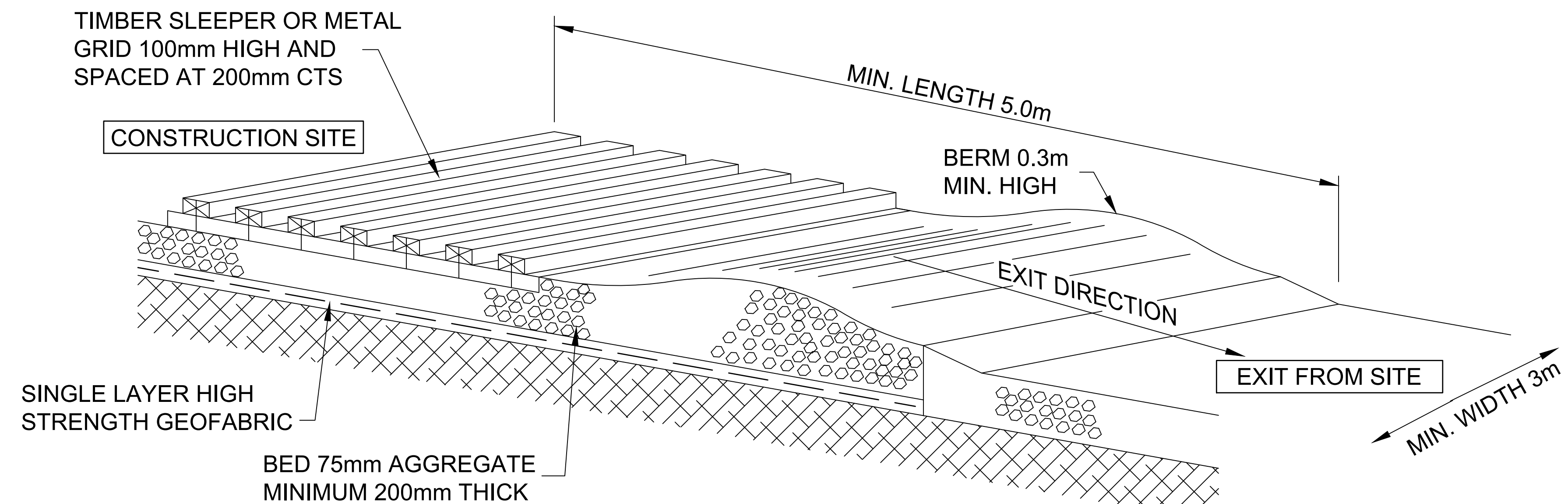

**TEMPORARY CONSTRUCTION VEHICLE EXIT**  
NTS

**NOTE:**  
ALL UTILITIES ARE TO BE ACCURATELY LOCATED BY  
CONTRACTOR BEFORE CONSTRUCTION.

REV	DATE	REVISIONS	DRN	CHK
1	22/05/24	PRELIMINARY - FOR APPROVAL	IB	DB

DESIGNED: DB	DATUM: AHD	A1
DRAWN: IB	COORDINATE SYSTEM:	
CHECKED: VC	APPROVED:	
RECOMMENDED:	PROJECT MANAGER	DATE
	PROJECT DIRECTOR	DATE

**CUBO**  
CONSULTING  
CUBO CONSULTING PTY LTD  
ABN: 46 610 277 452  
Elizabeth Court - Shop 16, 30 Karalla Road, Erina NSW  
Phone: (02) 4326 0990 Email: admin@cubo.net.au

MR G. MONK c/- FUTUREBUILD GROUP P/L  
PROPOSED RESIDENTIAL DEVELOPMENT & CABINS  
4948 CLARENCE TOWN ROAD  
TABBIL CREEK NSW 2420  
SEDIMENT AND EROSION CONTROL DETAILS

DRAWING STATUS:	FOR APPROVAL
NOT TO BE USED FOR CONSTRUCTION PURPOSES	
DRAWING NUMBER:	REV
24006-CI-036	1



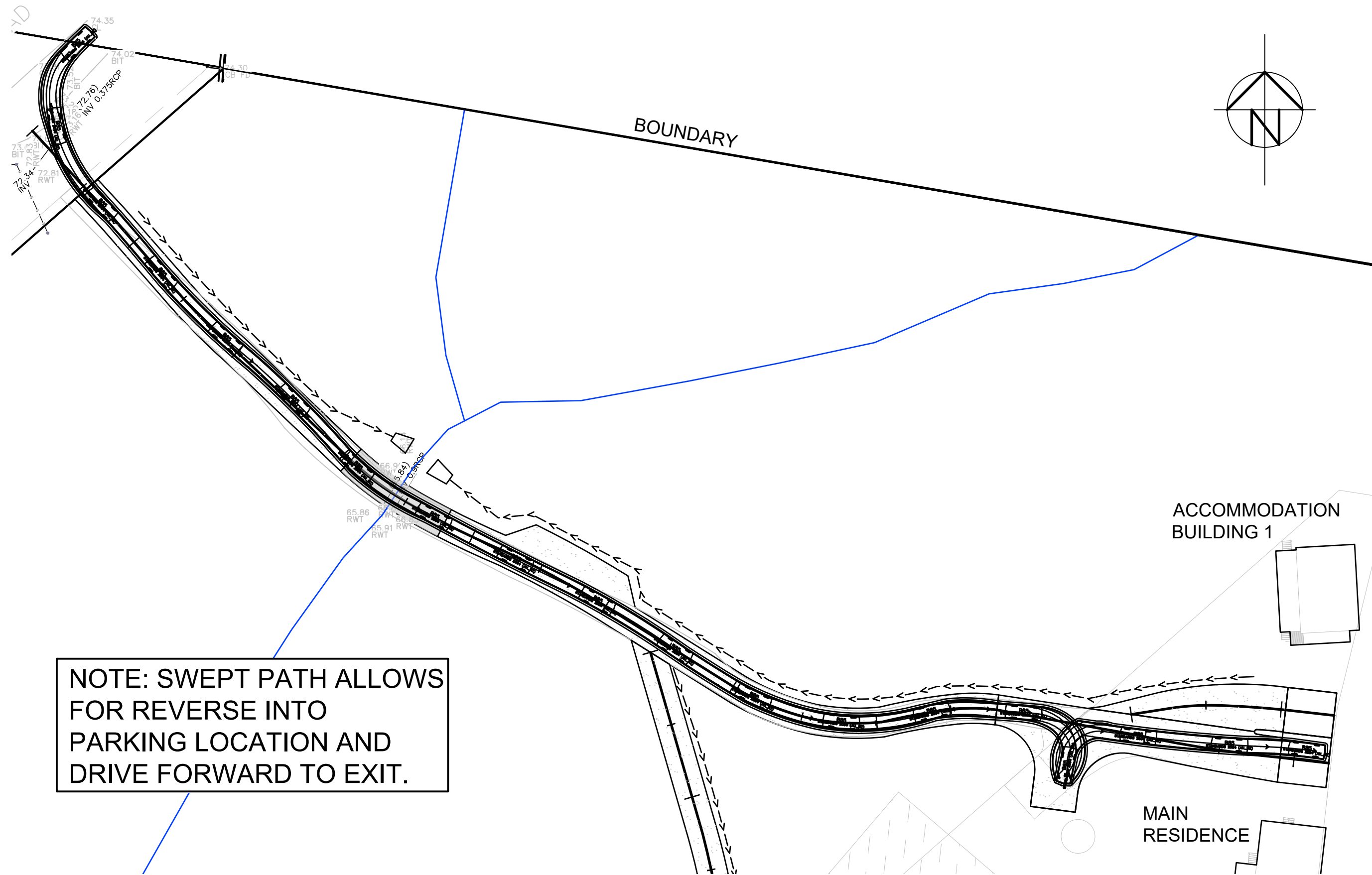

B85 SWEEP PATH - ENTER MAIN RESIDENCE  
SCALE 1:500 @ A1

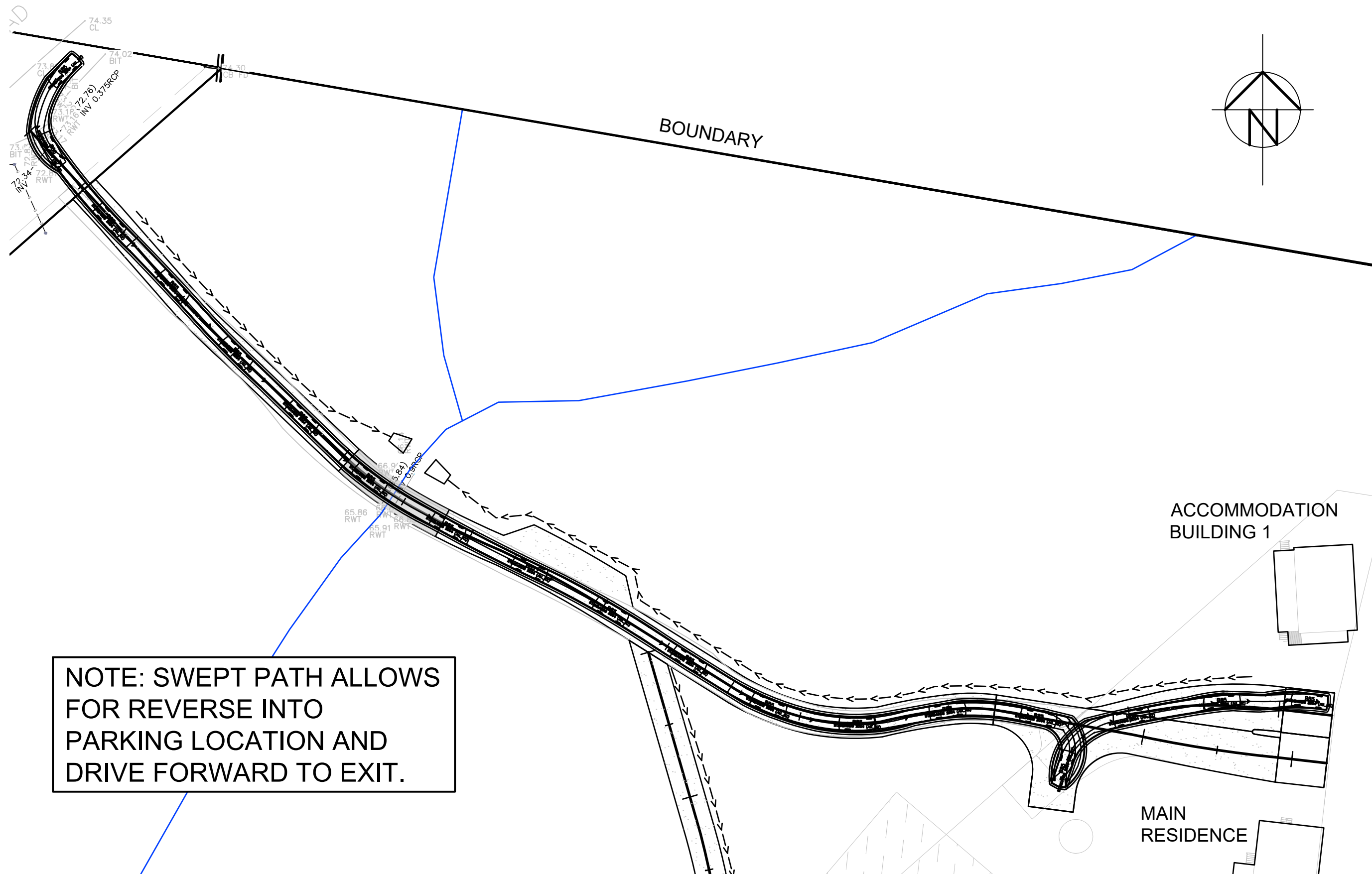

B85 SWEEP PATH - ENTER ACCOMMODATION BUILDING 1  
SCALE 1:500 @ A1

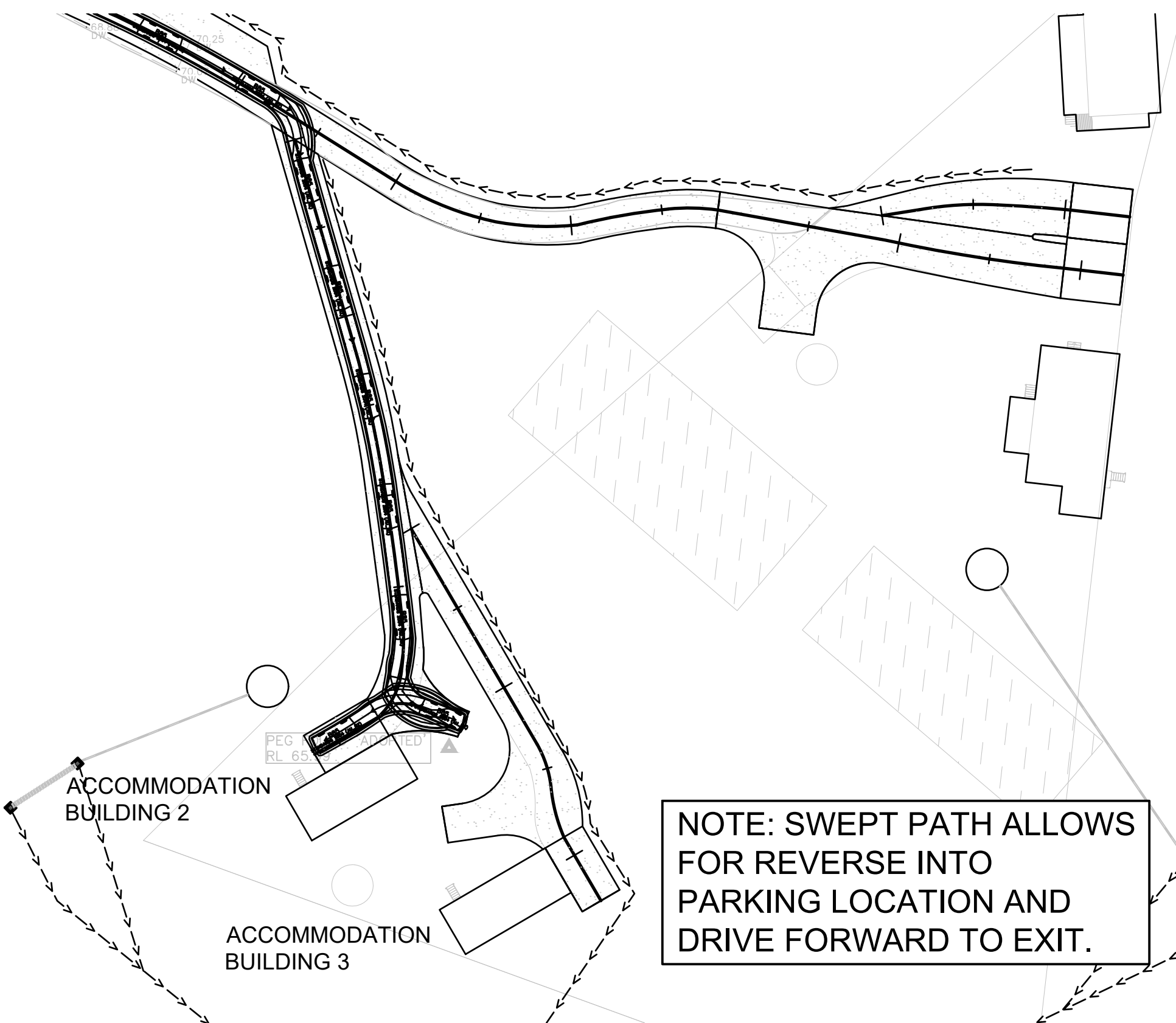
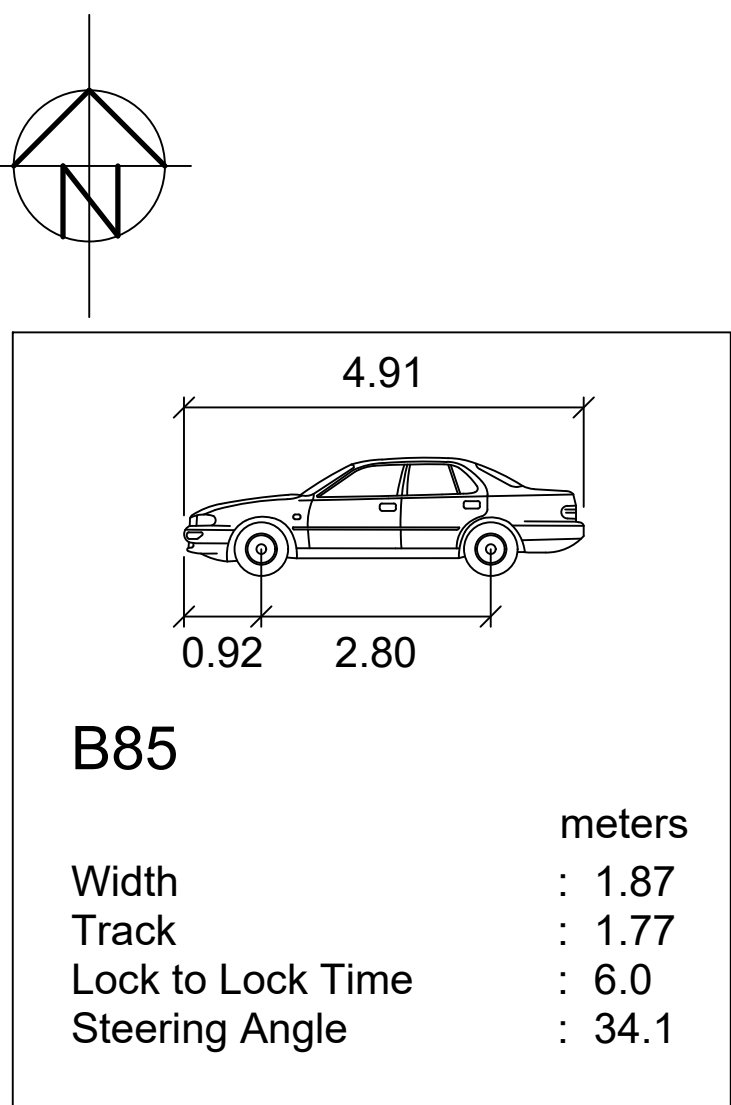

B85 SWEEP PATH - ENTER ACCOMMODATION BUILDING 2  
SCALE 1:500 @ A1

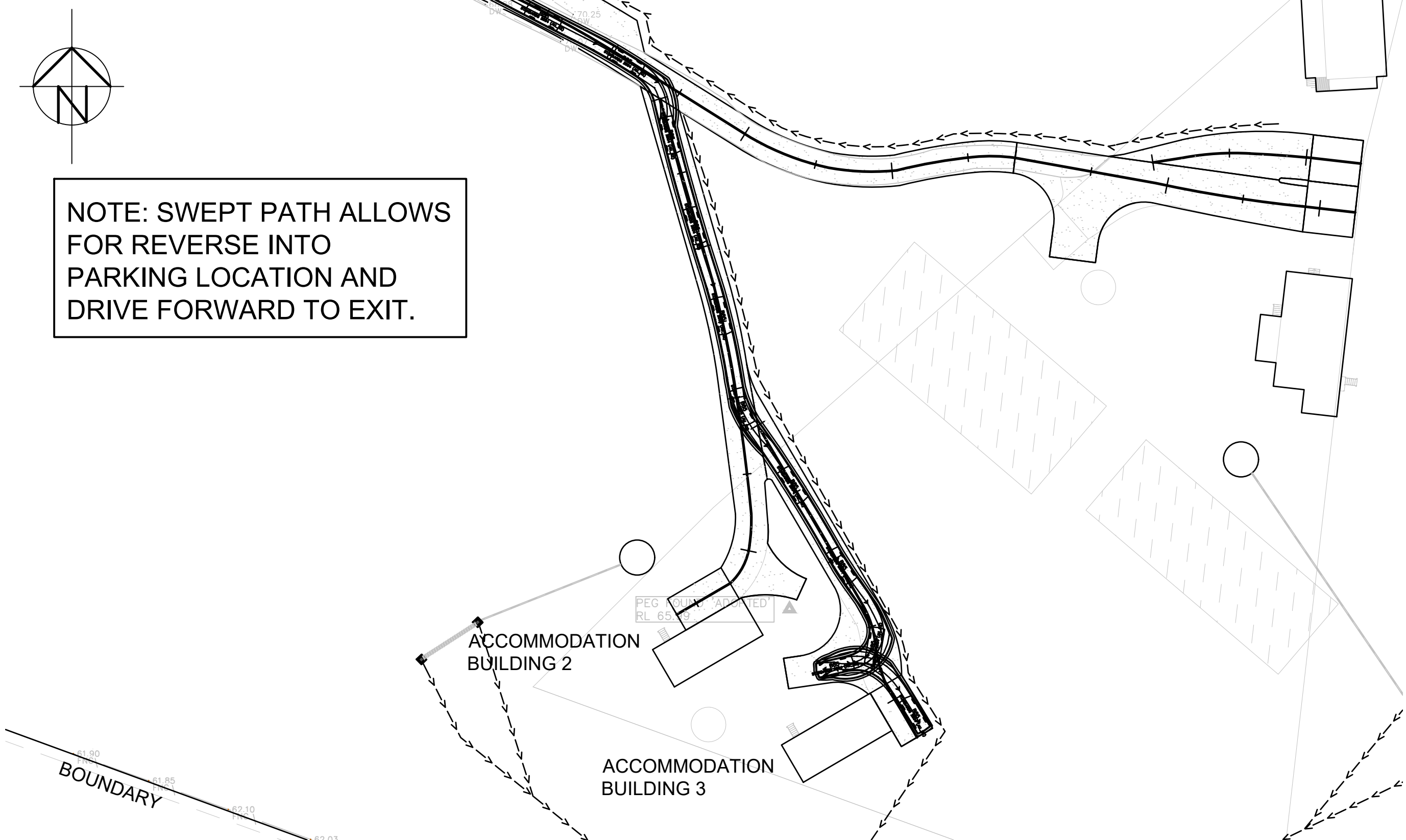

B85 SWEEP PATH - ENTER ACCOMMODATION BUILDING 3  
SCALE 1:500 @ A1

REV	DATE	REVISIONS	DRN	CHK
1	22/05/24	PRELIMINARY - FOR APPROVAL	IB	DB

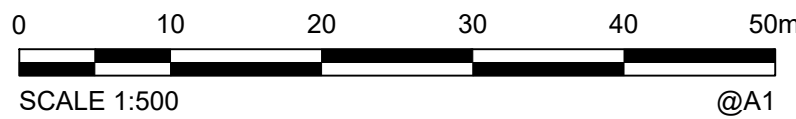

DESIGNED: DB	DATUM: AHD	A1
DRAWN: IB	COORDINATE SYSTEM:	
CHECKED: VC	APPROVED:	
RECOMMENDED:	PROJECT MANAGER	DATE
	PROJECT DIRECTOR	DATE

**Cubo**  
CONSULTING  
CUBO CONSULTING PTY LTD  
ABN: 46 610 277 452  
Elizabeth Court - Shop 16, 30 Karalla Road, Erina NSW  
Phone: (02) 4328 0990 Email: admin@cubo.net.au

MR G. MONK c/- FUTUREBUILD GROUP P/L  
PROPOSED RESIDENTIAL DEVELOPMENT & CABINS  
4948 CLARENCE TOWN ROAD  
TABBIL CREEK NSW 2420  
SWEEP PATHS - PASSENGER VEHICLE ALL BUILDINGS

DRAWING STATUS: <b>FOR APPROVAL</b> NOT TO BE USED FOR CONSTRUCTION PURPOSES	REV
DRAWING NUMBER: <b>24006-CI-050</b>	<b>1</b>